

MARKING CONTENT ON REVERSE SIDE:  
 PART NO. 21035260T-A 22.5\*11.75 15° DC DATE X X X  
 MAX LOAD 4500KG MAX KPA978 HDS 0 KBA XXXXX  
 (ACCORDING TO CUSTOMER REQUIREMENTS,  
 TYPEFACE:SIX TIMES NEW ROMAN,  
 THE DEPTH OF WORKS:0.3MM)

- ◆ Dynamic Unbalance
- 1、A ≤ 30G
- 2、B ≤ 30G
- 3、A+B ≤ 50G

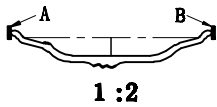

**Technical note:**

1. Compliance with US Federal Motor Vehicle Safety No. 120
2. Durability Test (SAE J267) Cornering Fatigue Test

- ★ -Loading Mode: 90°
- Load: 2117 ± 87kg.m
- Cycle: 300000

- ★ Radial Fatigue Test
- Load: 12660 ± 346kg.m
- Cycle: 100000

3. Tyre: 385/65R22.5, radius: 0.498m
4. Valve balance testing standards: max 2000g.cm
5. Valve: 40MS-00/TR553E
6. Valve nut torque: 80-125TN. LBS (8.95-14.64n. m)
7. Valve cap: TRVC2
8. Two pieces nuts M22-1.5, torque: 62/69kg.m
9. Tolerance

Dimensional Tolerance ± 1  
 Angle Tolerance ± 1°  
 Radius Tolerance ± 1

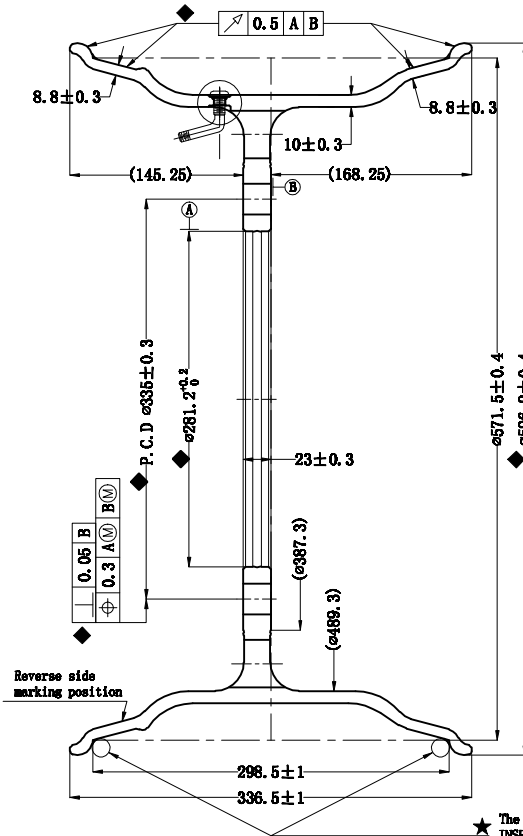
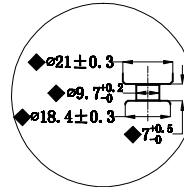

★ The ball with feet in diameter  
 INSPECT CIRCUMFERENCE  
 USING ø16MM  
 (0.629 INCHES)  
 DISE TAPE PER TIRE AND  
 RIM ASSOC SPECIFICATION

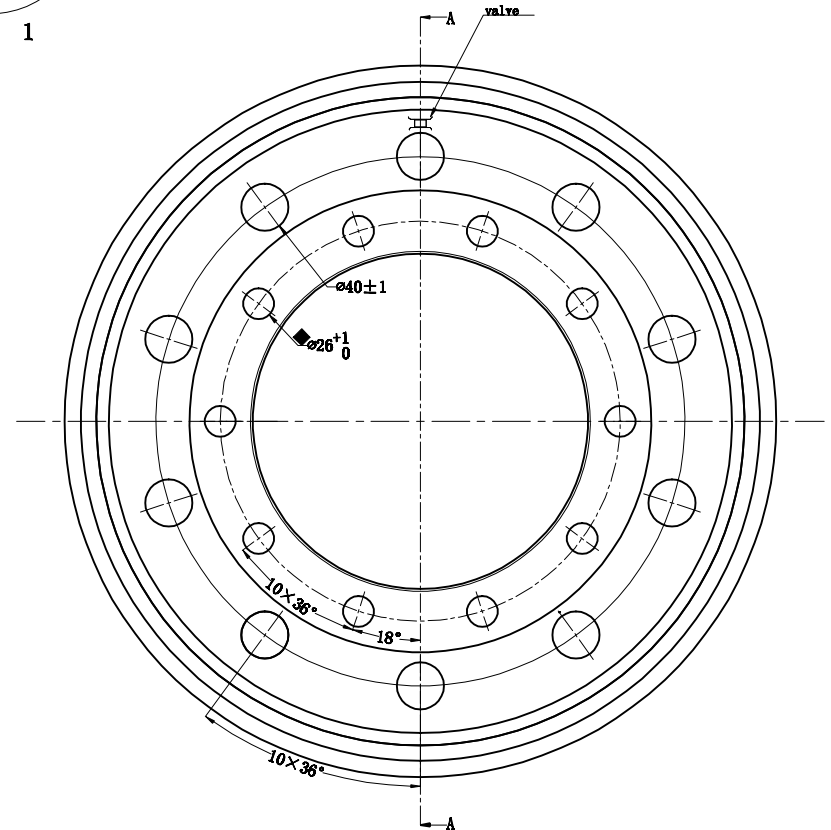

Changed the level	Place a few	Changed notification number	Changed content	Signature	Date

Important features	◆
Key Features	★

Design		Product picture	GT090-01T 22.5*11.75 ET: INSET/OUTSET 0/23	Drawing NO.	21035260T-A		
Proofreader		Vehicle model		Edition	Weight (Theory)	Percentage	
Examination		Surface treatment	Material/polishing	A/1	23.4kg	1:1	
Technology		Standardisation		A total of one		The first page	
Matification		Material	6061-T6	QINGDAO J&G			
Date		Projection marks					